

STOUGHTON ROAD



STOUGHTON ROAD

GUILDFORD, SURREY, GU2 9LR

A recently redecorated two double bedroom ground floor flat with patio, off street parking and bike lock up.

Available: 1st August 2025

£1,450 PCM (Per Calendar Month)

Flat, 2 Bedroom, 1 Bathroom, 1 Reception,
Unfurnished

Key Features

- Recently refurbished
- Two bedrooms
- Off street parking
- Family bathroom
- Modern kitchen





THE PROPERTY

Description

Internally, the property has been recently refurbished including flooring throughout. The ground floor apartment includes a spacious sitting room, modern kitchen with appliances including electric oven, washing machine and fridge/freezer. There are two double bedrooms and a new bathroom with a shower over the bath. The apartment benefits from a private patio and private entrance. Outside there is off street parking as well as a bike lock up.



Location

Stoughton Road is located just outside Guildford town centre with an excellent selection of local shops and restaurants, regular bus service into the town centre as well as the University plus providing excellent access to the A3 for onward travel.

Unfortunately no pets.

Available in August

EPC Rating C
Council Tax Band; B
Holding Fee; £334

NB The letting of this property is on behalf of a Connected Person to Grantley

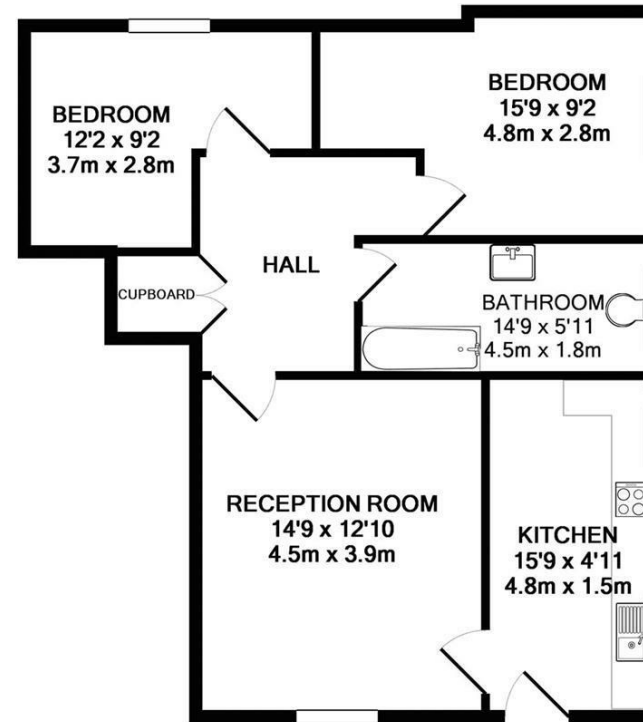

Whilst every attempt has been made to ensure the accuracy of the floor plan contained here, measurements of doors, windows, rooms and any other items are approximate and no responsibility is taken for any error, omission, or mis-statement. This plan is for illustrative purposes only and should be used as such by any prospective purchaser. The services, systems and appliances shown have not been tested and no guarantee as to their operability or efficiency can be given
Made with Metropix ©2017

Guildford

Poyle House 24 Epsom Road
Guildford
Surrey
GU1 3LE

Tel: 01483 407600

