

# GEORGE ROAD



# GEORGE ROAD

GUILDFORD, GU1 4NP

Central Guildford two bedroom apartment available immediately.

---

Available: 18th May 2025

£1,500 Per Month (Per Calendar Month)

Flat, 2 Bedroom, 1 Bathroom, 1 Reception, Unfurnished

## Key Features

- Central Guildford location
- Ground floor two bedroom apartment
- Recently redecorated throughout
- Driveway parking for small vehicle





## THE PROPERTY

### Description

Situated in a convenient and sought after location, we are very pleased to offer this spacious two bedroom ground floor apartment which has been recently redecorated throughout. The apartment offers comfortable and practical living and comprises generous open plan kitchen/reception, two well proportioned bedrooms and contemporary shower room.



## Location

George Road is located in a very central location within walking distance of most of Guildford's amenities, including the main line station, restaurants, shops and leisure facilities.

The property is available immediately  
Guildford Borough Council tax band C  
EPC E  
Holding deposit £346  
Driveway parking for small vehicle



## George Road, Guildford, GU1

Approximate Area = 581 sq ft / 53.9 sq m  
Limited Use Area(s) = 4 sq ft / 0.3 sq m  
Total = 585 sq ft / 54.3 sq m  
For identification only - Not to scale

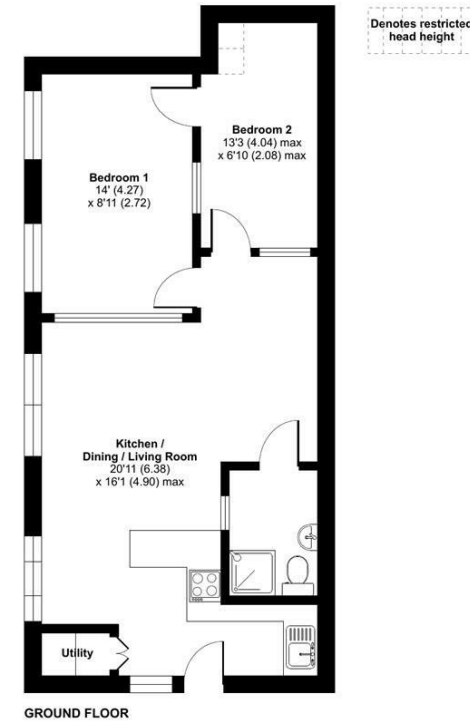

Floor plan produced in accordance with RICS Property Measurement 2nd Edition, Incorporating International Property Measurement Standards (IPMS2 Residential). © rtdrecom 2025. Produced for Grantleys. REF: 1288607

## Guildford

Poyle House 24 Epsom Road  
Guildford  
Surrey  
GU1 3LE

Tel: 01483 407600

