

HIGH STREET





HIGH STREET

GODALMING, SURREY, GU7 1EA

A two-bedroom ground-floor apartment located just off Godalming High Street with direct access to a communal garden.

Available: 22nd December 2023

£1,300 PCM (Per Calendar Month)

Flat, 2 Bedroom, 1 Bathroom, 1 Reception,
Unfurnished

Key Features

- Ground Floor
- One Bathroom
- Highstreet Location
- Two Bedroom
- Communal Garden



THE PROPERTY

Description

A ground-floor apartment with a fully equipped kitchen, appliances include a cooker, washing machine, fridge, and hob. The sitting room has plenty of natural light and provides direct access to the communal garden. The layout comprises a kitchen/living room, two spacious double bedrooms, and a family bathroom with a shower.

Outside, the property has access to a communal garden for all residences.



Location

Burgess House is located just off Godalming High Street, within walking distance of Godalming Mainline Station as well as the local shops, supermarkets, and pubs.

Unfortunately, no pets

EPC: C

Waverley Borough Council tax band: C Approximately £1,859 (2023/24)



Burgess House, Angel Court, High Street, Godalming, GU7

Approximate Area = 551 sq ft / 51.2 sq m
For identification only - Not to scale

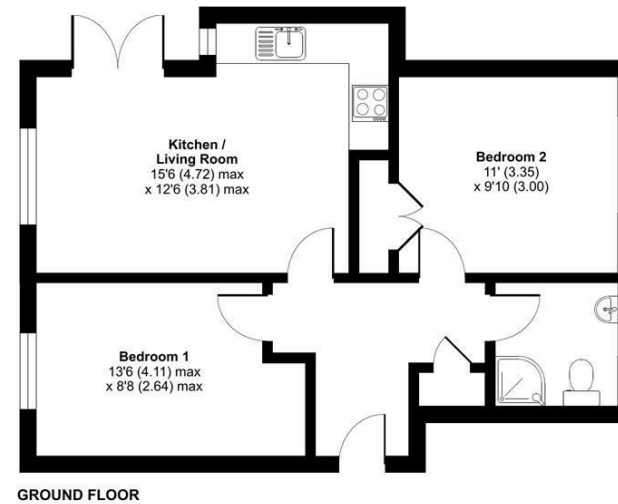

 Certified Property Measurer
Floor plan produced in accordance with RICS Property Measurement Standards incorporating International Property Measurement Standards (IPMS2 Residential). © nichecom 2023. Produced for Grantleys. REF: 1057184.

Guildford

Poyle House 24 Epsom Road
Guildford
Surrey
GU1 3LE

Tel: 01483 407600

