

MEADOW BANK



MEADOW BANK

FARNHAM, SURREY, GU9 7XN

A 3/4 bedroom townhouse in a very peaceful location overlooking meadowland on the edge of Farnham town centre. A few minutes' walking distance to West Street restaurants, shops and amenities.

Available: 14th October 2024

£1,990 PCM (Per Calendar Month)

House - Terraced, 4 Bedroom, 2 Bathroom, 2 Reception, Unfurnished

Key Features

- Peaceful residential location
- Within walking distance of the town
- Garden
- Parking for one car
- 3/4 bedrooms





THE PROPERTY



This well presented three/four bedroom townhouse occupies a very peaceful position opposite meadowland on this sought-after development which is within easy walking distance of Farnham town centre.

The accommodation comprises : Entrance hall, cloakroom, study/occasional guest bedroom, fully equipped utility room, cream Shaker kitchen with all appliances and spacious breakfast/dining area having double doors to the terrace and pretty garden. First floor : spacious sitting room, family bathroom and single bedroom. Second floor: master bedroom with excellent range of fitted wardrobes and en-suite shower room, further double bedroom with built-in wardrobes and store cupboard and airing cupboard. Parking.

EPC rating 'C'.
 Council Tax Band 'E'.
 Mains drainage
 Gas Central Heating

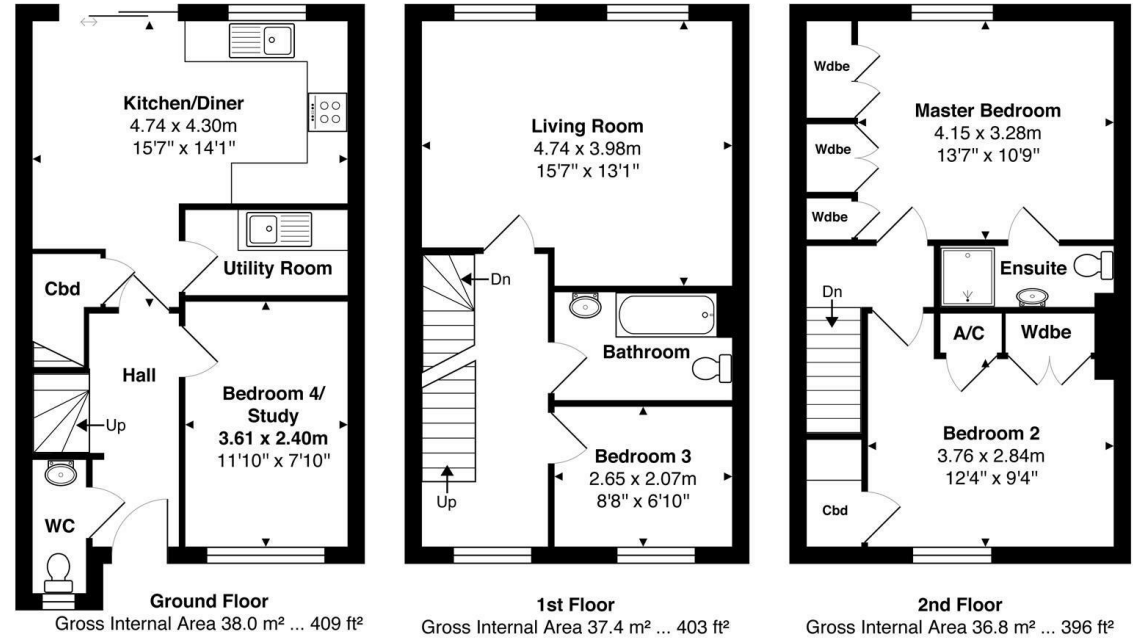

Total Approx. Gross Internal Area 112.2 m² ... 1208 ft²
 All measurements are approximate and for display purposes only. Not to scale.



Haslemere Lettings

24 West Street
 Haslemere
 Surrey
 GU27 2AH

Tel: 01428 651241

