

HARVEY ROAD,  
 GUILDFORD,  
 SURREY,

£1,025 PCM



0 Bedrooms . 0 Receptions . 1 Bathrooms . Studio

**Available From: 24th September 2022**

A light spacious recently refurbished studio flat, within easy reach of Guildford town centre and station with allocated parking for one car.

- Town centre location
- Off street parking for one car
- Neutrally decorated
- Gas central heating
- Available late September

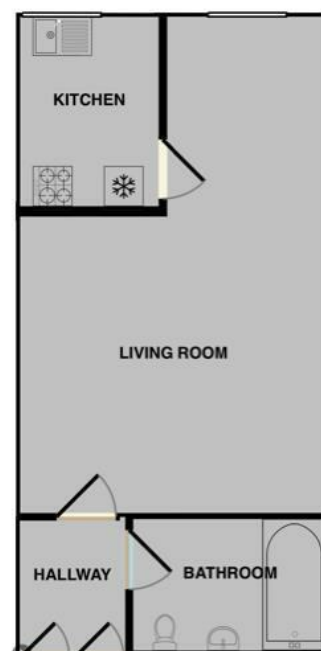



## Description

The flat has been refurbished to an exceptional standard, offering a fully fitted separate kitchen with eating area, a large L shaped reception room with storage cupboard, a beautifully tiled bathroom with a bath and shower over. There is also an entrance hall containing a storage cupboard housing a washer/dryer.

Including off road parking for one vehicle.

## Location

Harvey Lodge is conveniently located within walking distance of Guildford High Street, main line train stations and Stoke Park.

Available late September

Guildford Borough Council tax band B:  
£1,640.16 (2022/23)

EPC Rating C

