

# 4 COURTS MOUNT ROAD



# 4 COURTS MOUNT ROAD

HASLEMERE, SURREY, GU27 2PP

An immaculate home situated in a highly sought after location in the heart of Haslemere. Tucked away in a private setting and within walking distance to the town centre and main line station.

Available: 2nd May 2022

£4,250 Per Month (Per Calendar Month)

House - Detached, 3 Bedroom, 2 Bathroom, 2 Reception, Unfurnished

## Key Features

- Close to Town Centre
- Within short walk of station
- Elevated position
- Spacious rooms
- Double garage
- Ample parking
- Peaceful location





## THE PROPERTY



Entrance hall with wood flooring throughout.  
 Large spacious dining hall leading to steps up to triple aspect sitting room with gas fire and patio doors.  
 Fully fitted beech kitchen with door to utility conservatory, Study/4th bedroom. Conservatory with jacuzzi  
 Stairwell to landing with fitted cupboard. Master bedroom with en-suite bathroom  
 Family bathroom  
 Two further double bedrooms both with fitted wardrobes

Outside summer house  
 Pretty private garden to include landlord's gardener  
 2 x good size undercroft storage  
 Double garden and driveway with ample parking

No smoking  
 Not ideal for young children  
 Regret no pets



## Courts Mount Road, Haslemere, GU27

Approximate Area = 2509 sq ft / 233 sq m (includes garage & excludes void)  
 Outbuilding = 159 sq ft / 15 sq m  
 Total = 2668 sq ft / 248 sq m  
 For identification only - Not to scale

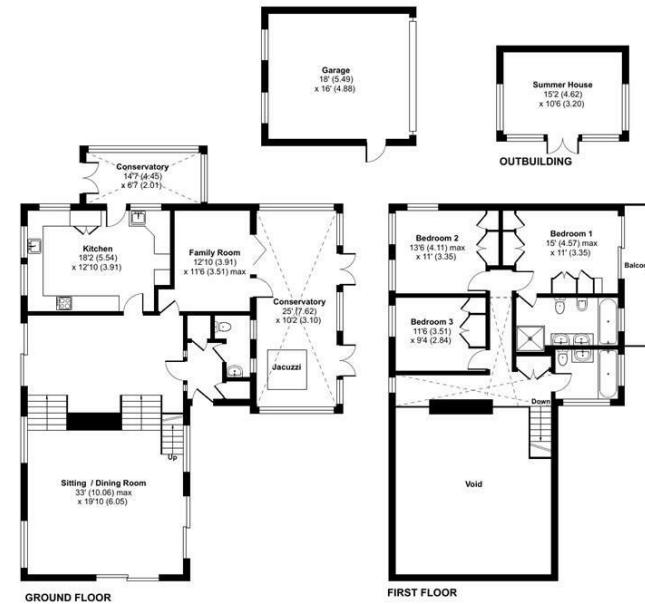

Floor plan produced in accordance with RICS Property Measurement Standards incorporating International Property Measurement Standards (IPMS2 Residential). © nichecom 2022. Produced for Grantleys. REF: 630491

## Haslemere Lettings

24 West Street  
 Haslemere  
 Surrey  
 GU27 2AH

Tel: 01428 651241

