

THE BELLERBY APARTMENTS



THE BELLERBY APARTMENTS

GUILDFORD, SURREY, GU1 4PT

High specification one bedroom apartment in Guildford town centre which is available for occupation from mid March.

Available: 18th March 2022

£1,300 PCM (Per Calendar Month)

Flat, 1 Bedroom, 1 Bathroom, 1 Reception,
Unfurnished

Key Features

- Town centre
- Luxury apartment
- Unfurnished
- One bedroom
- Secure parking





THE PROPERTY

Description

Internally the property is finished to a very high standard and has underfloor heating throughout. The kitchen comes with stone worktops, induction hob (pans included) and integrated Neff appliances including conventional oven, combination microwave oven, Fridge, freezer dishwasher and washer/dryer. The kitchen is open into the living room which has a large, floor to ceiling window which faces west. The bedroom is a double bedroom with a bigger than expected wardrobe and has a separate door into the very large bathroom, with separate bath and shower.



Location

The Bellerby Apartments is located in a very central location above the new Waitrose supermarket. It is a short stroll into the main shopping area of Guildford plus only 500 yards to Guildford mainline station and 0.6 miles to London Road Station.

EPC B



Leapale Lane, Guildford, GU1

Approximate Area = 473 sq ft / 43.9 sq m
For identification only - Not to scale

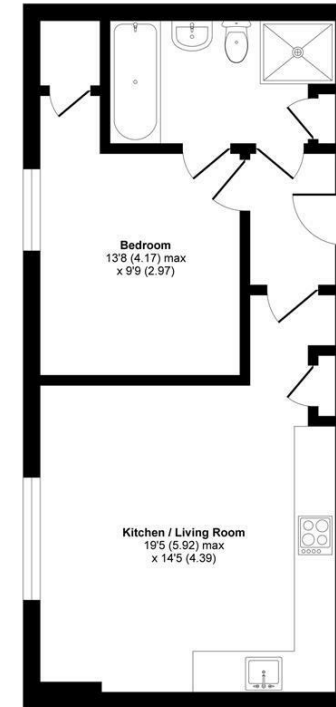

THIRD FLOOR



Floor plan produced in accordance with RICS Property Measurement Standards incorporating International Property Measurement Standards (IPMS2 Residential). © richcom 2020. Produced for Grantleys. REF: 585096

Guildford

Poyle House 24 Epsom Road
Guildford
Surrey
GU1 3LE

Tel: 01483 407600

